

MISS MIDI PURSE

The finished bag measures: 9" X 6" X 2"

The perfect bag for the women on the go.

Miss Midi is larger than a wallet and smaller than most purses.

It has 1 outside and 3 inside secure zippered pockets with sleeves, 20 slots for credit / loyalty cards. It will hold a mini tablet and a phone.

With the adjustable strap use it over the shoulder or as a cross body bag.

Fabric Requirements:

- | | | |
|-----------------------------------------|--------------------|---------|
| 1. Main Fabric (MF) | ½ yd. | 0.45 m. |
| Outside shell, strap | | |
| 2. Lining Fabric (LF) | 1 ⅛ yds. | 1.00 m. |
| Bag, sides inserts and zippered pockets | | |
| 3. Contrast Fabric (CF) | ⅔ yd | 0.60 m. |
| Zippered pockets, side inserts | | |
| 4. Binding Fabric (BF) | ⅞ yd | 0.80 m. |
| Bag binding, credit cards pockets | | |
| 5. RFID Fabric if desired | - 2 pieces 6" x 9" | |



Other Supplies

- ✂ Pellon 880F Sof-Shape® or light fusible (18" wide) 2 yds. 1.80 m.
- ✂ Pellon 809 Decor Bond or medium fusible (45" wide) ½ yd. 0.45 m.
- ✂ Pellon® 70 Peltex® 8" x 11" piece
- ✂ Pellon 805 Wonder Under 1 yds 0.90 m.
- ✂ 4 Zippers 8" or longer
- ✂ 2 Swivel Hooks ½" wide
- ✂ 2 "D" rings ½" wide
- ✂ 1 Slider ½" wide
- ✂ 1 Secure lock
- ✂ Rotary cutting mat 24" x 36"
- ✂ Rotary cutter with new blade
- ✂ 6" x 24" & 6" x 12" ruler,
- ✂ Colour matching thread
- ✂ Binding clips
- ✂ Seam ripper, basic sewing supplies



MISS MIDI PURSE



Finished size: 9" x 6" x 2"

COTTON TREASURE DESIGN © 2018

Visit: www.cottontreasuredesign.com

E-mail: info@cottontreasuredesign.com

www.facebook.com/cottontreasuredesign

1-778-472-1342

All rights reserved

Created in Canada

A COTTON TREASURE DESIGN

LIDIA K. FROEHLER

ACTD # 1025

MISS MIDI PURSE

Please read all instructions before cutting your fabric.

Use a scant ¼" seam allowance throughout the project unless indicated otherwise.

The ¼" seam allowance is included in all measurements

PLEASE photocopy and cut or cut out the labels on page 10 of this pattern and pin them to the fabrics you cut following the cutting chart. This will help you to easily find the components when they are called for throughout this pattern.

CUTTING INSTRUCTIONS:

MAIN FABRIC (MF)

- ◆ 3 pieces 2" x 8½" MF 1 - trim for pocket sleeves
- ◆ 1 piece 9½" x 20" MF 2 - outside shell of the bag
- ◆ 2 pieces 2¼" x 40" MF 3 - shoulder strap
- ◆ 1 piece 2" x 19" MF 4 - "D" ring strap

LINING FABRIC: (LF)

- ◆ 6 pieces 6" x 8½" LF 1 - zippered pockets
- ◆ 3 pieces 4" x 8½" LF 2 - pocket sleeves
- ◆ 2 pieces 6" x 9" LF 3 - back of CC pockets
- ◆ 1 piece 9½" x 22" LF 4 - bag lining
- ◆ 1 piece 8½" x 9" LF 5 - outside zippered pocket lining
- ◆ 2 pieces 8" x 11" LF 6 - front flap border. **Cut ½" LARGER on all sides than template "A"**
- ◆ 2 pieces 7" x 14" LF 7 - side insert linings (cut to template "B")

CONTRAST FABRIC: (CF)

- ◆ 6 pieces 6" x 8½" CF 1 - zippered pockets
- ◆ 3 pieces 4" x 8½" CF 2 - pocket sleeves
- ◆ 2 pieces 7" x 14" CF 3 - side inserts (cut to template "B")

BINDING FABRIC: (BF)

- ◆ 8 pieces 1½" x 2½" BF 1 - zipper tabs
- ◆ 2 pieces 9" x 23½" BF 2 - credit card pockets (CC)
- ◆ 2 pieces 1⅞" x 20" BF 3 - side inserts binding, must be cut on

BIAS

- ◆ 1 piece 2¼" x 40" BF 4 - bag binding

LIGHT FUSIBLE: (LTF)

- ◆ 6 pieces 6" x 8½" LTF 1 - zippered pockets
- ◆ 3 pieces 8½" x 9" LTF 2 - pocket sleeves
- ◆ 2 pieces 9" x 23½" LTF 3 - credit card pockets (CC)
- ◆ 1 piece 5" x 9" LTF 4 - back side of lining
- ◆ 1 piece 1" x 54" LTF 5 - shoulder strap (it can be 2 pieces butted together when fusing)

MEDIUM FUSIBLE (Décor Bond) (MDF)

- ◆ 1 piece 9½" x 22" MDF 1 - bag lining
- ◆ 1 piece 9½" x 20" MDF 2 - outside shell of the bag

PELTEX (PE)

- ◆ 1 piece 8" x 11" PE 1 - front flap border (cut to template "A")

WONDER UNDER (WU)

- ◆ 2 pieces 8" x 11" WU 1 - front flap border (cut to template "A")
- ◆ 2 pieces 7" x 14" WU 2 - side inserts (cut to template "B")

Hint....

*For most efficient cutting
start with the largest piece
in a fabric group*

*RFID Fabric if desired
2 pieces 6" x 9"
To protect cards
from identity theft.*

ZIPPERED POCKETS

You will need the following:

Pockets: CF 1, LF 1, LTF 1

Sleeves: MF 1, CF 2, LF 2, LTF 2

Zipper tabs: BF 1

Zippers: 4 zippers 8" or longer

Applying the zipper tabs.

1. Fold each zipper tab to be 1¼" x 1½".
2. Find the center of the zipper and make a mark ¾" away from the center on both ends.
3. Place the raw edge of the tab on the mark with the fold facing the center and the tab centered on the zipper.
4. Sew twice across with ¼" seam allowance. Make sure the zipper pull is between the tabs.
5. Trim the ends of the zipper even with the raw edges of the zipper tabs, finger press the tab to the outside.
6. Trim the zipper tab even with the zipper tape.
7. The zipper with the tabs should be 9" long.

Using the instructions from above finish the remaining 3 zippers.

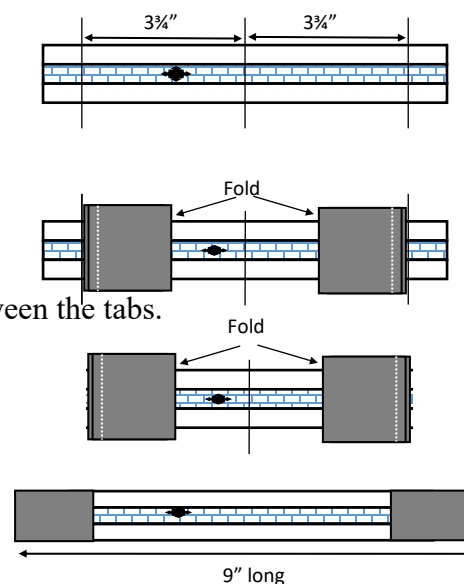

NOTE Zipper tabs will be ¼" longer on each end than the pockets

You will use 3 zippers for the inside of the bag and the 4th one will be used later on the outside of the bag.

Preparing the pocket sleeves.

1. With right sides together sew the trim MF 1 to the Pocket Sleeves CF 2 with a scant ¼" seam allowance.
2. With right sides together sew lining fabric LF 2 to the other side of the trim.
3. Press the seams in one direction, apply the light fusible LTF 2 to the back of the sleeve.
4. Fold in half lengthwise so the trim is even on both sides and the bottom edges are even.
5. Stitch in the ditch at the base of the trim and top stitch the top edge.
6. Each sleeve should finish at 4½" x 8½"

Note: Now is a good time to play with your decorative stitch options on your machine.

Do a decorative stitch down the center of the trim if you wish.

Making inside zippered pocket.

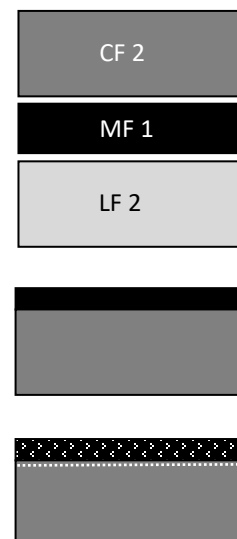

Fuse all corresponding pieces of LTF 1 to CF 1 for the zippered pockets.

1. Take one 6" x 8½" rectangle of fused front fabric and place right side up.
2. Place the zipper right side down with zippered tabs overhanging by a ¼" on each side.
3. Place 6" x 8½" piece of lining fabric LF 1 right side down, all edges even.
4. Sew with a scant ¼" seam allowance.
You might want to use a zipper foot for this step.
5. Repeat the above steps on the other side of the zipper making sure the fabrics are all aligned on both ends.
6. Press both sides away from the zipper making sure there are no pleats and top stitch both sides of the zipper.
7. Fold in half at the zipper matching the bottom edges (pin if needed). Measure from the top of the zipper 5½" to the bottom of the pocket. Trim if needed.
The pocket should measure 5½" x 8½" with the zipper tabs overhanging by ¼" on each end.
8. Repeat above steps for the other two zippered pocket.

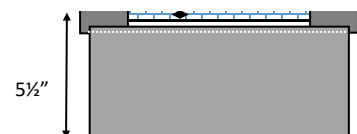
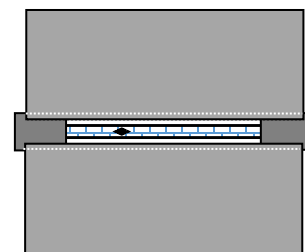
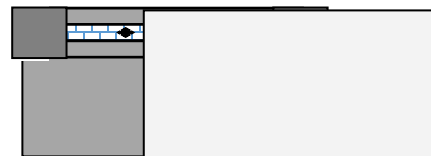

The next step is where we attach the sleeve to the front of the zippered pocket.

If you have a preference for the direction of zipper pulls, now is the time to make the decision.

Two of mine are opening from left to right, one opens from right to left and I placed them alternating.

9. Place the sleeves on the front of the zippered pockets, sides and bottom even.

Stitch bottom and both sides with ⅛" seam allowance up to the zipper tabs to secure all layers in place, then finish the same edges with a narrow zig zag. **DO NOT TRIM THE ZIPPER TABS!!!**

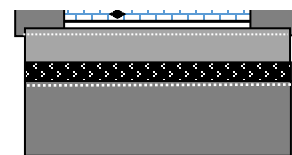

CREDIT CARD POCKETS

You will need the following:

BF 2, LTF 3, LF 3 plus RFID fabric if desired.

1. Apply the light fusible interfacing to the back of the BF 2 (9" x 23½")



2. With fine pencil draw lines as

per diagram on the interfacing side, do not worry if the last section is less than 3".

3. Make your first fold at the 2¾" line to the front, (right side together), then your second fold at 1¾" from the previous one is made to the back (fusible side together). Continue in this order to the end of the piece, leaving the 3" tail at the bottom.
4. Make sure the folded piece is straight and edges are aligned, press and top stitch the top edge of each pocket.
5. Mark and stitch the center line of the CC pockets to divide them, use a decorative stitch if you would like to.
6. Place the 6" x 9" lining fabric right sides together with the top of CC pockets and stitch across with a ¼" seam allowance. Fold to the back and press.
7. Insert the R F I D fabric if desired between the CC pocket and lining.
8. Top stitch the top edge and sides
9. Trim to 5" from the top.
Finished CC pocket should measure 5" x 9"
10. Repeat the above to make a second set of CC pockets.

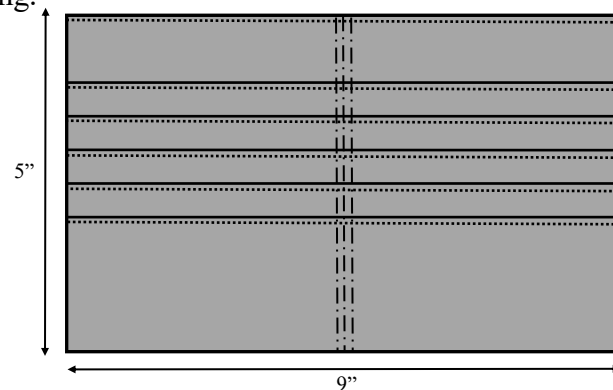

Construction of the inside of the bag.

You will need the following:

LF 4, MDF 1, LTF 4,

1. Apply the medium fusible to the wrong side of the lining.
2. On the MDF side, as per diagram mark a line 6" from one end of the lining and a ¼" line along each long side of the remaining 16".
Cut away the marked ¼" x 16" strip on each side.
3. Cut the lining fabric into 6 pieces as per diagram. **A, B, C, D, E, F**, flip over all pieces so the lining side is up

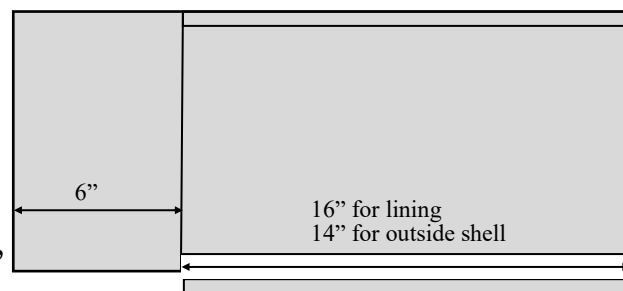

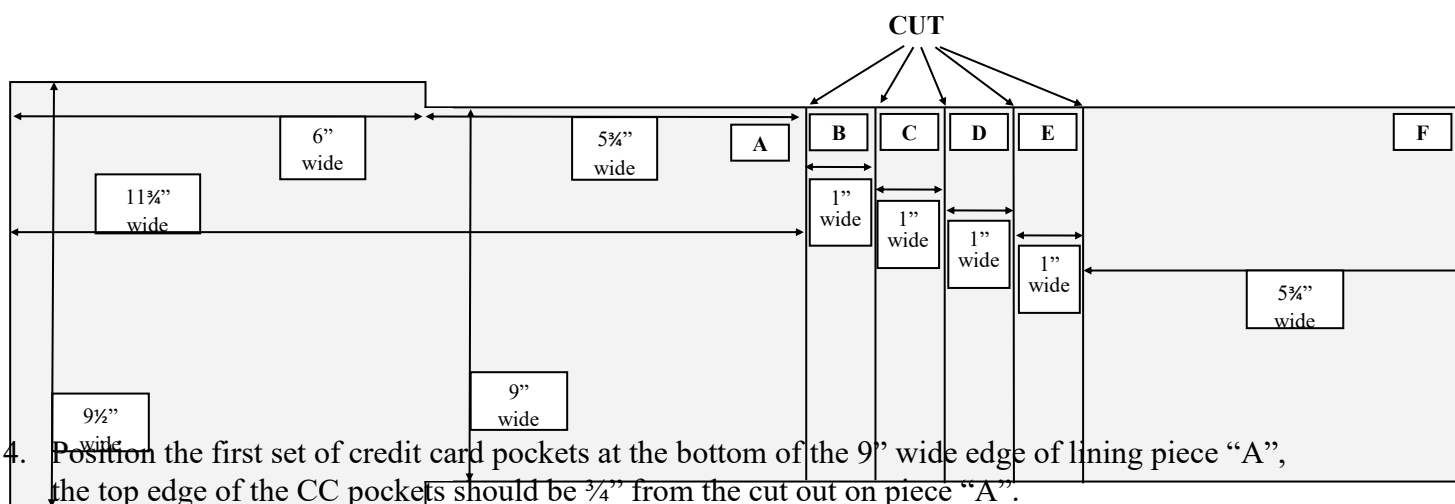

4. Position the first set of credit card pockets at the bottom of the 9" wide edge of lining piece "A", the top edge of the CC pockets should be $\frac{3}{4}$ " from the cut out on piece "A".
Stitch both side edges with a scant $\frac{1}{8}$ " seam allowance to secure.
5. Position the second set of credit card pockets at the bottom edge of lining piece "F", the top edge of the CC pockets should be $\frac{3}{4}$ " from the top edge of piece "F".
Stitch both side edges with a scant $\frac{1}{8}$ " seam allowance to secure.
6. Place lining piece "B" right sides together on the bottom edge of the Credit card pocket and piece "A" combination and sew with a scant $\frac{1}{4}$ " seam allowance back stitching at the beginning and the end.
Press to the outside.
Flip to the back and stitch on the very outside edge of the seam allowance to hold the seam allowance in place.
7. Consider the orientation of the zipper pulls, center and align the bottom edge of the first zippered pocket with the opposite long edge of piece "B" and place piece "C" right side down.
With scant $\frac{1}{4}$ " seam allowance sew across the bottom, back stitching at the start and end, press open. (you should have a $\frac{1}{4}$ " of lining showing on each side at the bottom of zippered pockets).
8. Center and align the bottom edge of the second zippered pocket with the opposite long edge of piece "C" and place piece "D" right side down.
With scant $\frac{1}{4}$ " seam allowance sew across the bottom, back stitching at the start and end and press open.
9. Center and align the bottom edge of the third zippered pocket with the opposite long edge of piece "D" and place piece "E" right side down.
With scant $\frac{1}{4}$ " seam allowance sew across the bottom, back stitching at the start and end and press open.
10. With right sides together place the credit card pocket piece "F" combination on the opposite long edge of piece "E". With scant $\frac{1}{4}$ " seam allowance sew across the bottom, back stitching at the start and end.
Press toward the center.
Flip to the back and stitch on the very outside edge of the seam allowance to hold the seam allowance in place.
11. Re-press the 3 center seams to be open and flat
12. Take the 5" x 9" rectangle of light fusible interfacing and fuse it on the back over the open seams on the bottom of the zippered pockets to keep them open and flat.
13. The finished lining with inserted zippered pockets should be 19" long.

OUTSIDE SHELL / ZIPPERED POCKET

You will need the following:

MF 2, LF 5, MDF 2 and 4th zipper with tabs.

1. Fuse the interfacing to the wrong side of the fabric.
2. As per diagram on page 4, mark a line 6" from one end of the fabric and a $\frac{1}{4}$ " line along each long side of the

remaining 14". Cut away the marked $\frac{1}{4}$ " x 14" strip on each side.

- Cut the long strip at $1\frac{1}{4}$ " away from the notch ($7\frac{1}{4}$ " from the wide end).

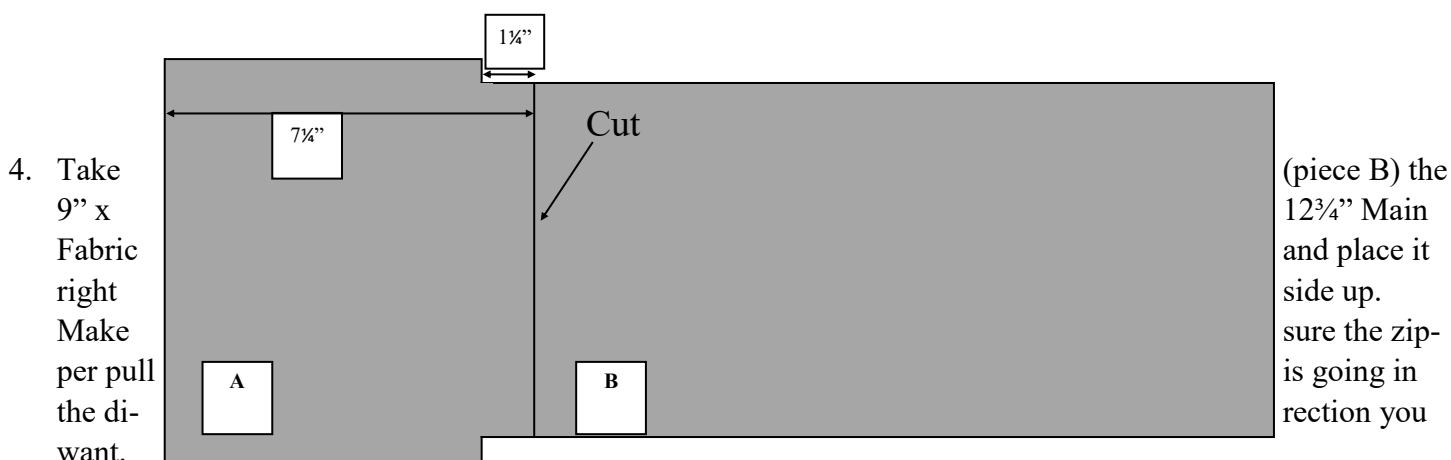

Place the zipper right side down on top of the Main Fabric and place the pocket lining LF 5 right down on top of the zipper. Sew with a scan $\frac{1}{4}$ " seam allowance.

- Press the Main Fabric and pocket lining away from the zipper tape. Top stitch close to the zipper tape.
- Bring the other side of the pocket lining fabric back so the right side is against the back side of the zipper tape, pin in place and flip over so you can see the front of the zipper
- Take piece A and place the 9" edge of the Main Fabric right side down on top and even with the zipper tape. Stitch with a scan $\frac{1}{4}$ " seam allowance.
- Press the Main Fabric away from the zipper and keep the bottom of the pocket toward the long part of the Main Fabric.
- Top stitch the other side of the zipper.
- After the zipper is sewn in trim from the narrow end to make the bag shell 19" long.

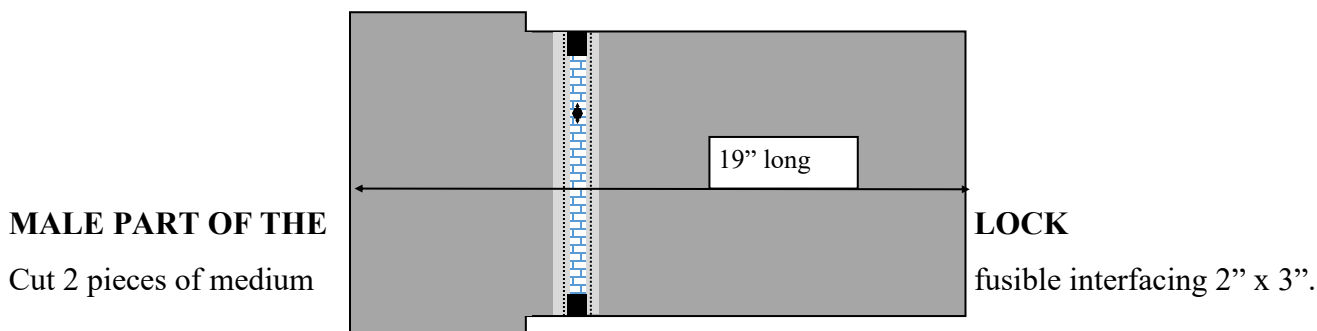

1. On the right side of the bag shell following the diagram, mark the hardware location $3\frac{1}{2}$ " from the narrow end of the bag shell making sure it is centered.

If you plan to carry a lot of stuff and need extra room in bag, you could mount the male part of the lock closer to the outside edge but do not go less $2\frac{1}{2}$ " from the narrow end.

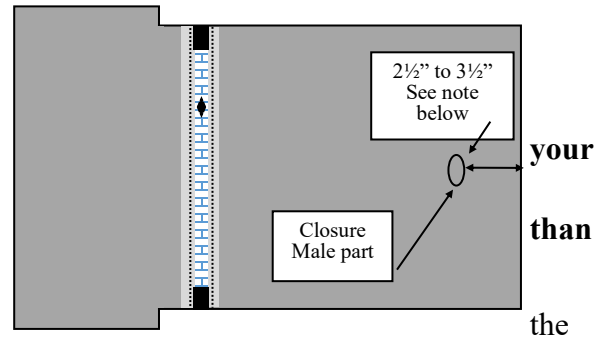

2. Fuse 1 piece of the precut interfacing on the wrong side of bag shell to cover the hardware location you just marked on the other side.
3. Following the manufacturers instructions, install the "male" part of the closure and apply the second precut piece of interfacing over the back side of the hardware to cover the metal plate.
4. Turn the piece over and top stitch around the lock to reinforce it. Take care not to strike the backing plate.

OUTSIDE TRIM / BORDER

You will need the following:

PE 1, WU 1, LF 6

1. Fuse the two Wonder Under pieces to the Peltex, one on each side.
2. Peel the paper off the Wonder Under on **one side only**.
3. Place the peeled side of the Peltex on the wrong side of the Lining Fabric LF 6) and fuse making sure the Peltex is centered and you can see an equal amount (about $\frac{1}{2}$ "") of fabric all the way around the edge of the Peltex.
4. Now place the second piece of Lining Fabric (LF 6) right sides together with the piece that is already fused to the Peltex, all edges even.
5. Stitch on both ends and around the INSIDE of the "U" shape as close as possible to the Peltex, back stitching at the beginning and the end. Trim the seam allowance inside the "U" shape and both ends to $\frac{1}{8}$ ".
6. Peel the remaining Wonder Under paper.
Flip the second layer of fabric to the un-fused side of the border, pin in place making sure the stitching line connecting both pieces of fabric is nicely lined up with the inside of the "U" shape (you might need to pull a little). Once you are happy with the results fuse in place. Stitch around the outside of the Peltex as close as possible. Trim the outside seam allowance to $\frac{1}{4}$ ".

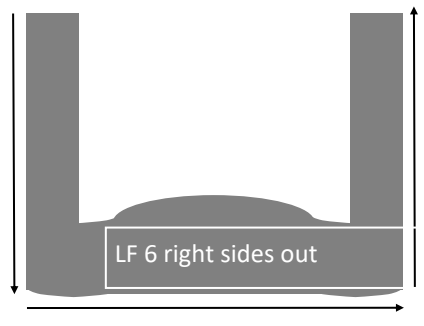
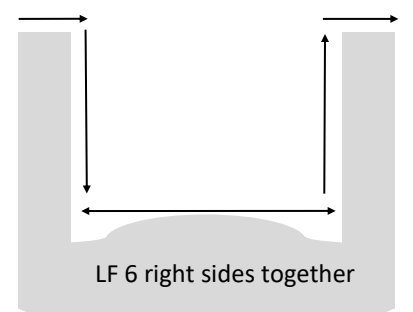
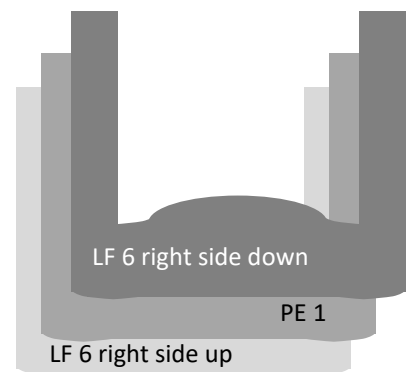

OUTER SHELL ASSEMBLY

7. Position the decorative border on the wide end of the outside fabric. Pin in place with outside edges even and the ends matched to the notch cut out).

With matching thread, top stitch the ends and the INSIDE edge of the border.
Then secure the outside edge to the shell by stitching along the existing stitch line.
This will give you a line to follow in the next step.

8. Lay out the inside of the bag right side up, place the outside shell right side down align the notches and the wider part of the bag shell.
9. With a back stitch to secure, start at one notch and sew with a scant $\frac{1}{4}$ " seam allowance around the wide part of the bag (following the previous stitch line) to the other notch and back stitch to finish.
10. Trim the outside corners to remove bulk. Turn right side out, paying attention to the ends of the seams so they do not open. Back stitching should help. Steam and manipulate the corners and edges so they line up nicely. It may feel like you have too much fabric on the outside (front) of the bag. While you are steaming the edge, roll the outside fabric toward the lining until everything lays flat. Once you are happy with the corners and edges, top stitch the border all around close to the outside edge.
11. Now it's time to secure both layers of the bag flap in preparation for the lock. Stitch through the flap along the inside edge of the border.
12. With the lining side up and all raw edges even, stitch the long sides only with a $\frac{1}{8}$ " seam allowance.
13. Stitch in the ditch at the bottom of one of the credit card pockets. Flip the zippered pockets over and stitch in the ditch at the bottom of the other credit card pocket. Do two more stitch lines through the center of the strips that separate the zippered pockets.

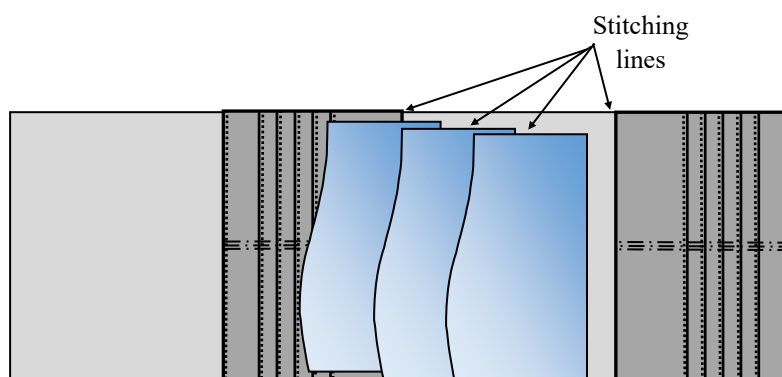
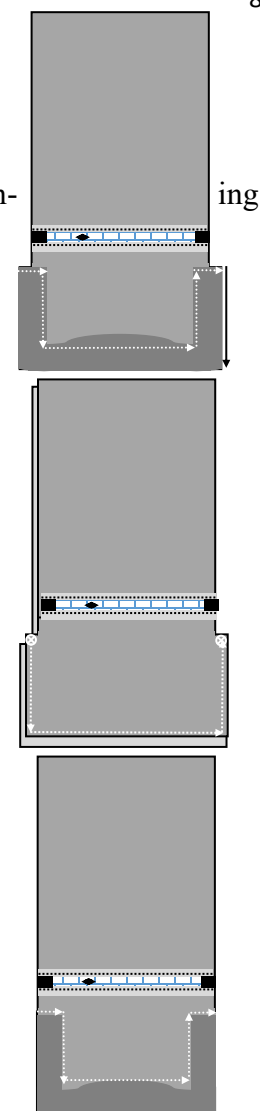

SIDE INSERTS

You will need the following:

CF 3, LF 7, WU 2, BF 3, BF 4

1. Fuse one piece of Wonder Under to the wrong side of each of the two Contrast Fabric (CF 3) pieces.
2. Peel the paper from the Wonder Under and place the Lining Fabric (LF 7) pieces on top right side up, All rights reserved. No part of this pattern may be photocopied or reproduced without the expressed consent of Cotton Treasure Design.

© 2018 A Cotton Treasure Design

3. Take the two pieces of bias binding that are 1 7/8" x 20", press in half lengthwise. Apply to the Contrast Fabric side of the side inserts along the curved edge by machine with a scant 1/4" seam allowance. Fold to the lining side and finish by hand or machine.
4. Place the template on the lining side of the side inserts and using an erasable marker transfer the placement for the zippered pockets.

Attaching the side inserts and binding

1. With the lining side down and curved edge toward center, pin in place the side insert starting at the base of the border and ending at the raw edge at the other end of the bag. Stitch with a scant 1/4" seam allowance, back stitching at the beginning and the end, fold the zippered pockets out of the way while you are stitching. Repeat above for second insert.

2. Take the binding strip of fabric, remove the selvedge from one end. Fold the end under 1/2" and press, then press in half lengthwise. We are applying binding now while you can make everything lay flat for sewing.

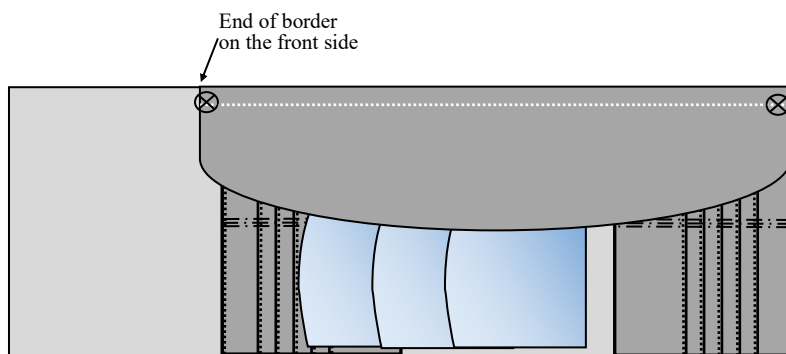

Sew the binding **to the outside of the bag** starting at the border and going around the bag to finish at the other end of the border. Back stitch at the beginning and the end.

When you get to the end of the first long side stop a 1/4" before the corner.

Open both side inserts to the outside and make the fold in your binding to go around the corner, continue sewing to the next corner. Stop 1/4" before the turn, make the pleat in the binding, fold the insert back under and continue sewing. Stop about 3" short of reaching the border, trim the binding 1/2" longer than needed. Open the binding, fold in the extra 1/2" and refold. Finish sewing to the border and backstitch. Fold around to the inside and finish by hand or machine.

SHOULDER STRAP CONSTRUCTION AND "D" RING HOLDER

You will need the following:

MF 3, MF 4, LTF 5

Hardware - 1 - 1/2" slider
 2 - 1/2" swivel snap hooks
 2 - 1/2" "D" rings

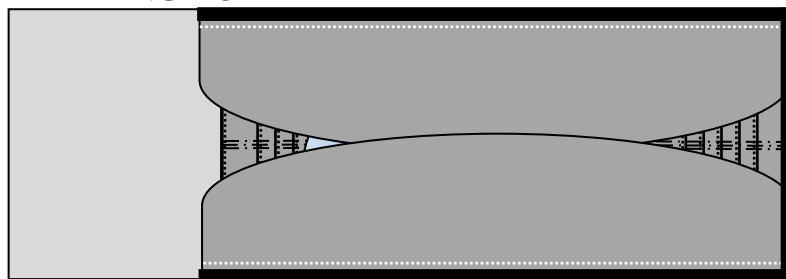

“D” ring holder

1. Take MF 4 and fold in half lengthwise with wrong sides together and stitch the length with a scant $\frac{1}{4}$ ” seam allowance.
Roll the tube so the seam is down the center of the strip and press the seam open.
The strip should measure $\frac{3}{4}$ ” x 19”.
2. Put the strip through two “D” rings, bring the two ends together and whip stitch or zig zag butted ends to hold them together and flat.
3. With the butted ends in the middle, slide one “D” ring out to each end of the loop.
Stitch across the strip/loop to secure the “D” ring in place.

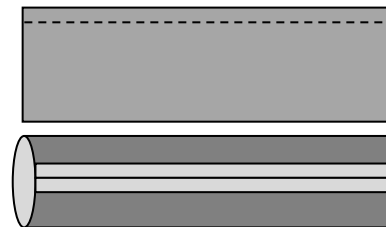

Tip: When sewing across a narrow strip I like to start in the middle stitch to one outside edge then back stitch all the way to the other edge and repeat.

4. Place the strip with the butted seam down on the underside of the bag flap next the binding of the side inserts. Pin in place making sure that the “D” rings are equally spaced in relation to the flap and both layers of the strap are one on top of the other.
5. Top stitch on both sides of the strip turning across the strip just before the stitch line from the flap trim as seen on the under side of the flap.

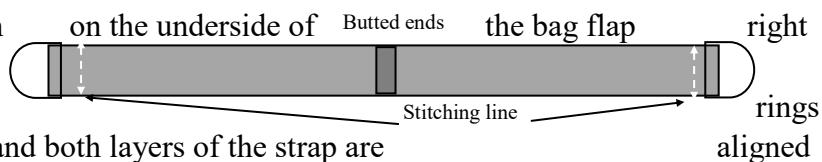
**Shoulder strap**

1. Take the two $2\frac{1}{4}$ ” wide strips of MF 3 and join then end to end with a diagonal seam, trim the corner, press open. See diagram.
2. Trim this strip to be 55” long.
3. Apply the LTF 5 to the wrong side of the

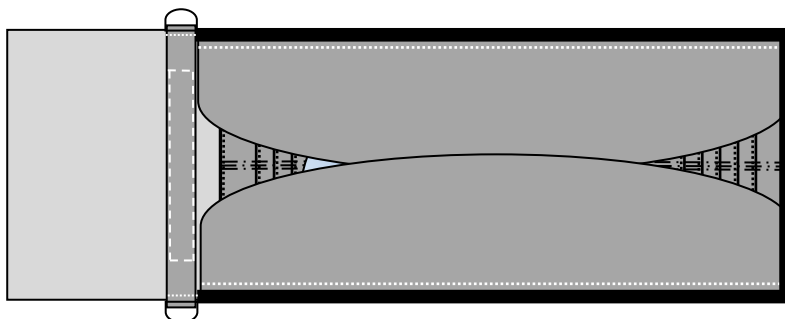

strip, placing the interfacing at the center of the strip so an equal amount of fabric is showing on both long edges and at both ends.

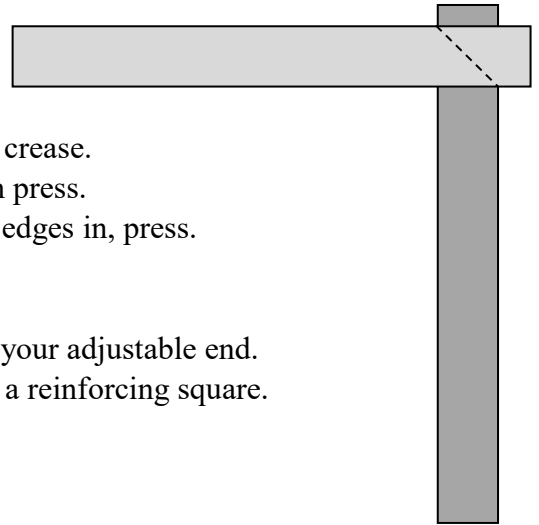

4. Press in half lengthwise, wrong sides together to create a center line crease. Open the strip and fold both raw edges to the center line crease, then press.
5. Fold $\frac{1}{4}$ " on both ends and then fold the strip in half lengthwise, raw edges in, press.
6. Top stitch the strap along both long sides and both ends.
7. Attach slider to one end, sew a reinforcing square.
8. Feed the strap through the hook and back through the slider. This is your adjustable end.
9. Attach the second hook to the other end of the strap and secure with a reinforcing square.

ATTACHING ZIPPERED POCKETS TO THE SIDE INSERTS

1. Start with the middle pocket standing straight up and aligned with the center mark on the side insert. Wrap the side insert around the end of the pocket and pin in place or use binding clips, make sure to press the zipper tab down to cover the end of the pocket. Mark 3" from the top edge of the bias binding (this is where you will stop sewing).
2. Stitch in place with a $\frac{1}{4}$ " seam allowance. Place the needle about $\frac{1}{2}$ " below the binding and start stitching in reverse until you get to the outside edge of the binding, then stitch forward to the 3" mark and back stitch to secure. Repeat on the other side and the two remaining pockets.

FEMALE PART OF THE LOCK

Find the center of the bag flap and make a mark $\frac{3}{4}$ " from the bottom edge (this may change depending on the type of the hardware you choose).

This is the location for the female part of the lock to be installed following the manufacturer instructions.

The design of the bag will give you very easy access to all compartments, it opens very wide and because of that, please choose a secure lock.

If you find that the bag opens more than you need / like you can reduce it by pinching the middle of the side insert between the zippered pockets and tacking by hand about a $\frac{1}{4}$ " from the fold.

Thank you for purchasing this pattern from Cotton Treasure Design.

Enjoy your bag and Happy Quilting.

Lidia

PHOTOCOPY THIS PAGE, CUT AND USE TO LABEL WHEN CUTTING FABRIC

MF 1 Trim for pocket sleeves	MF 2 Outside shell of the bag	MF 3 Shoulder strap	MF 4 “D” ring strap
LF 1 Zippered pockets	LF 2 Pocket Sleeves	LF 3 Back of CC pockets	LF 4 Bag lining
LF 5 Outside zippered pocket lining	LF 6 Front flap border (cut to template “A”)	LF 7 Side insert linings (cut to template “B”)	CF 1 Zippered pockets
CF 2 Pocket sleeves	CF 3 Side inserts (cut to template “B”)	BF 1 Zipper tabs	BF 2 Credit card pockets (CC)
BF 3 Side inserts binding Must be cut on BIAS	BF 4 Bag binding	LTF 1 Zippered pockets	LTF 2 Pocket sleeves
LTF 3 Credit card pockets (CC)	LTF 4 Back side of lining	LTF 5 Shoulder strap	MDF 1 Bag lining
MDF 2 Outside shell of the bag	PE 1 Front flap border (cut to template “A”)	WU 1 Front flap border (cut to template “A”)	WU 2 Side inserts (cut to template “B”)

This template sheet should be printed on 11" x 17" paper

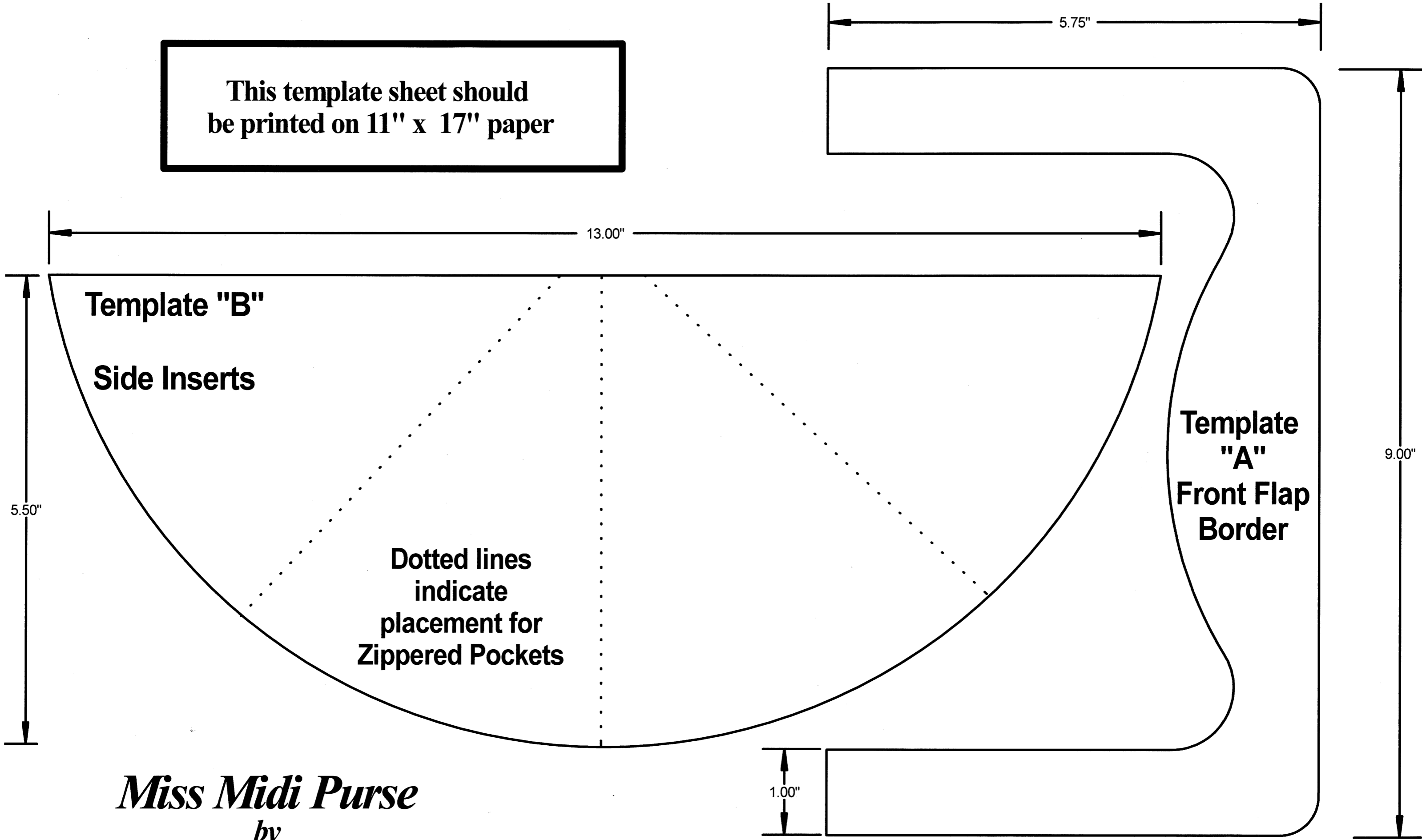

Miss Midi Purse
by
Cotton Treasure Design